

VESTIÁRIO VISTA A ESC. 1:25

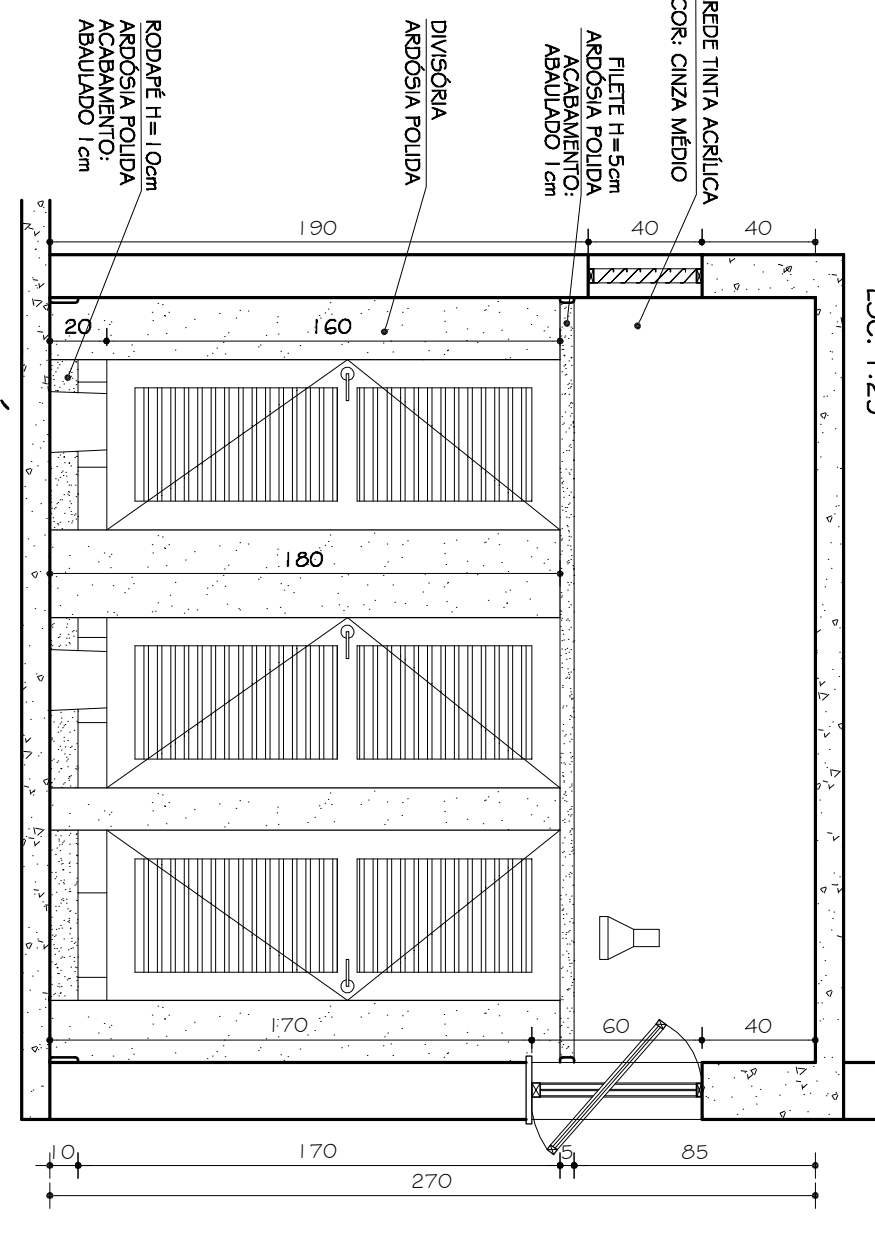

VESTIÁRIO VISTA B ESC. 1:25

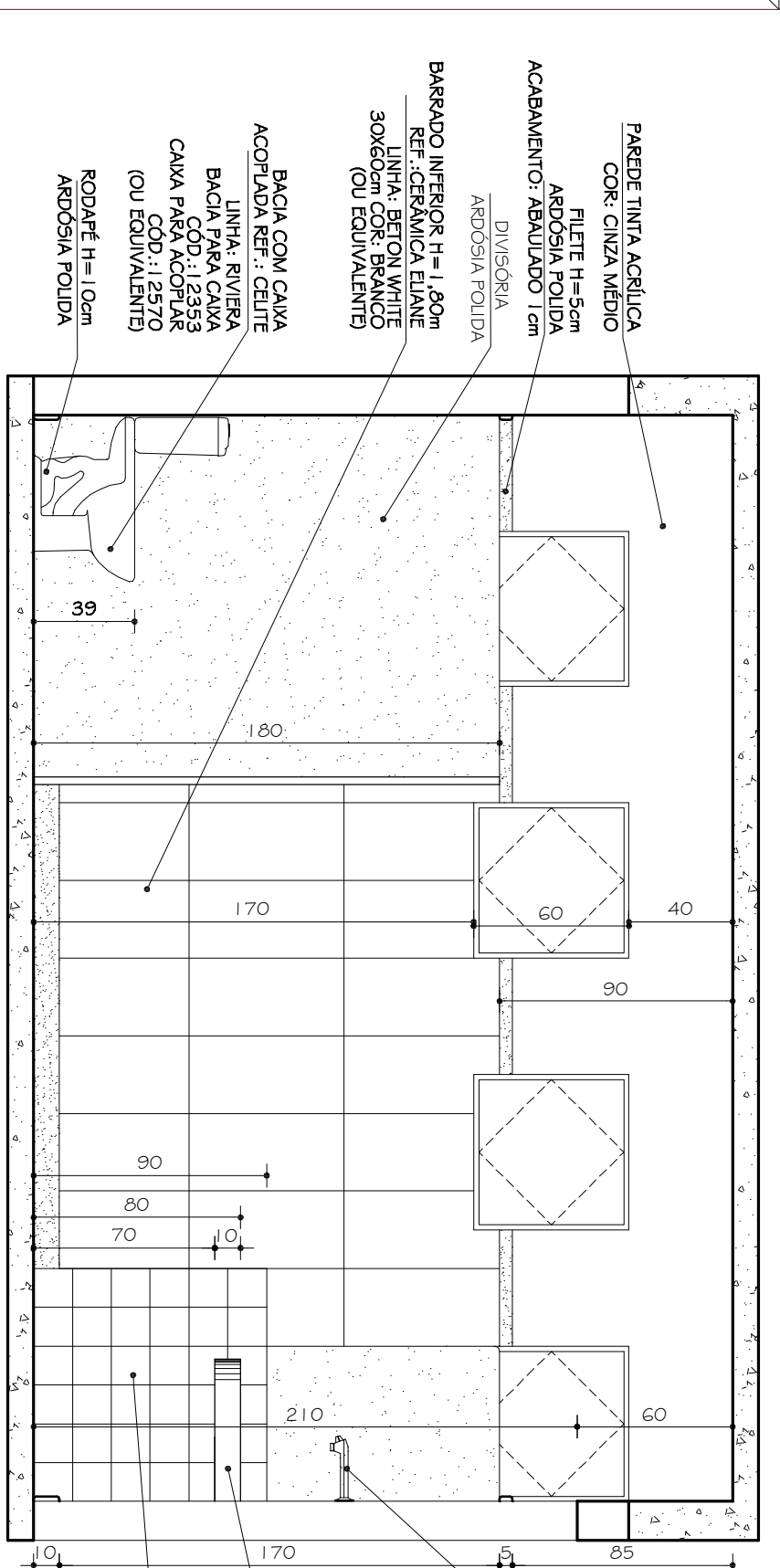

VESTIÁRIO VISTA C ESC. 1:25

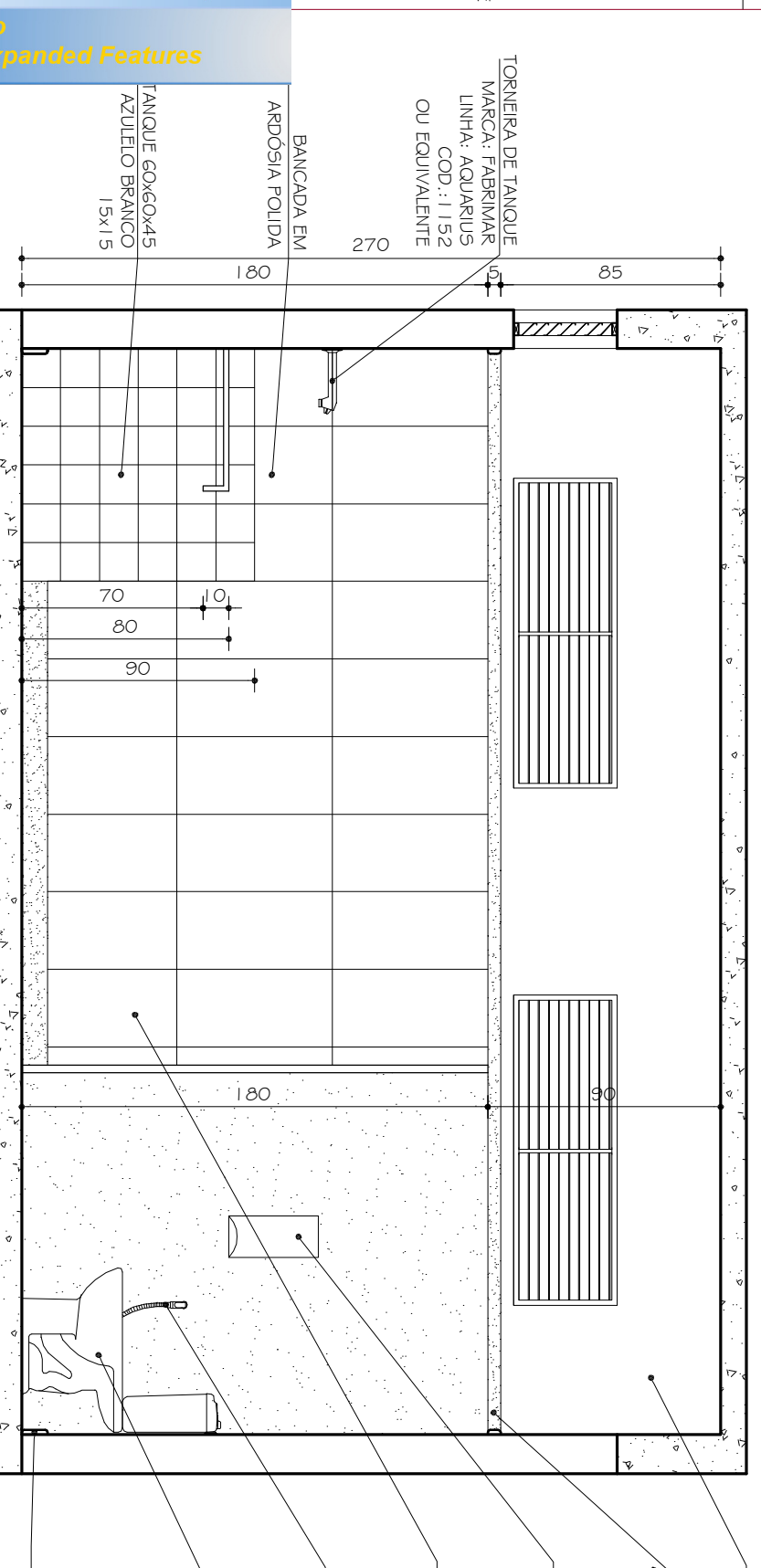

VESTIÁRIO VISTA D ESC. 1:25

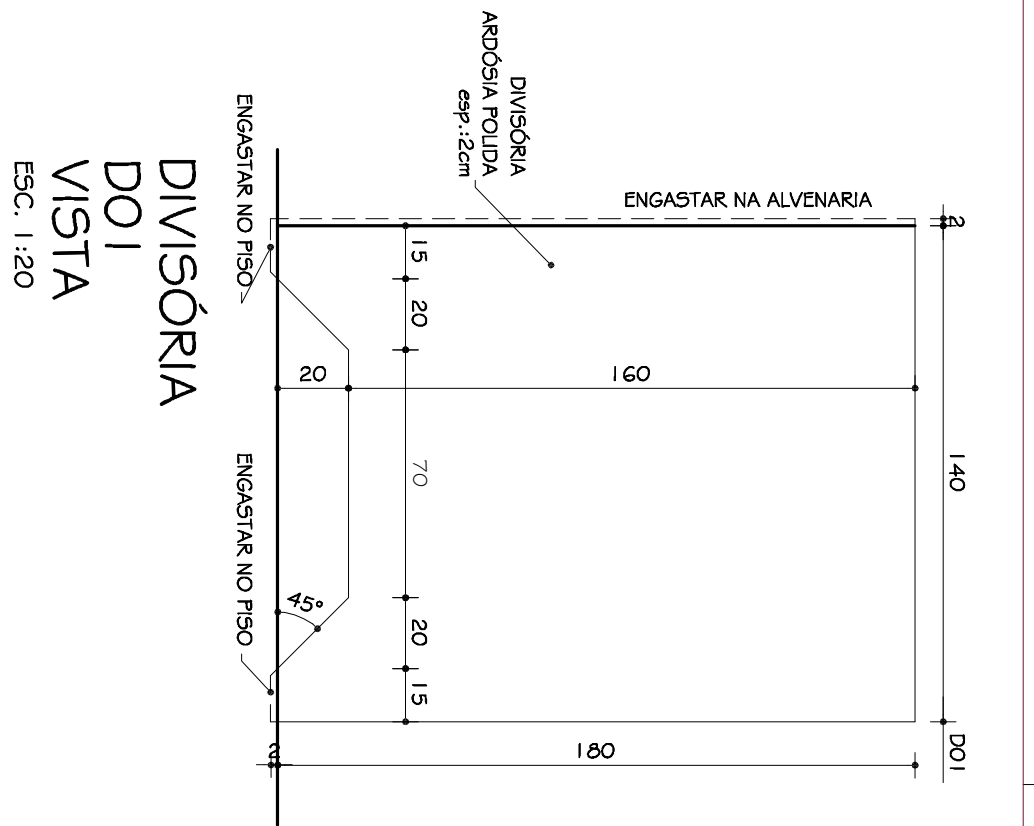

DIVISÓRIA DO1 VISTA ESC. 1:20

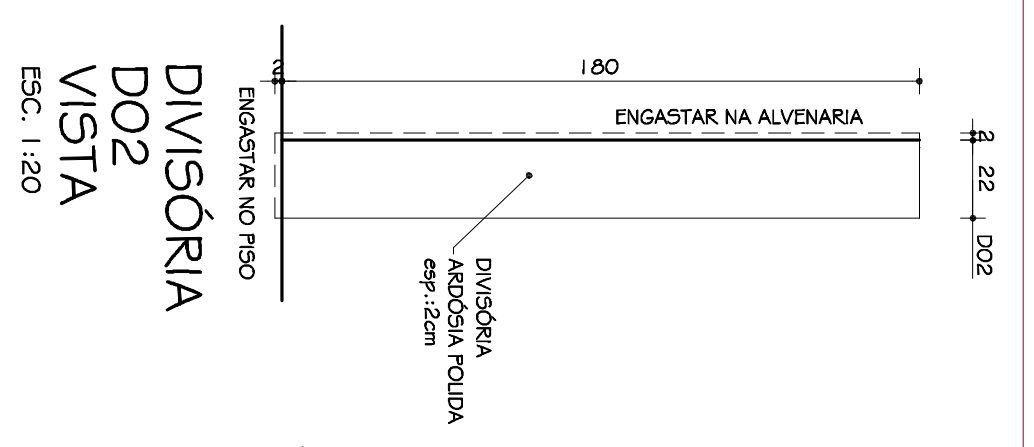

DIVISÓRIA DO2 VISTA ESC. 1:20

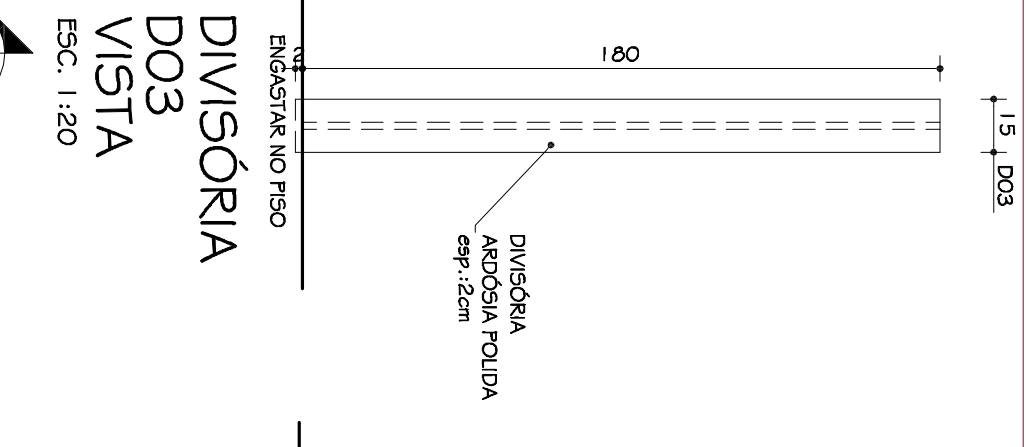

DIVISÓRIA DO3 VISTA ESC. 1:20

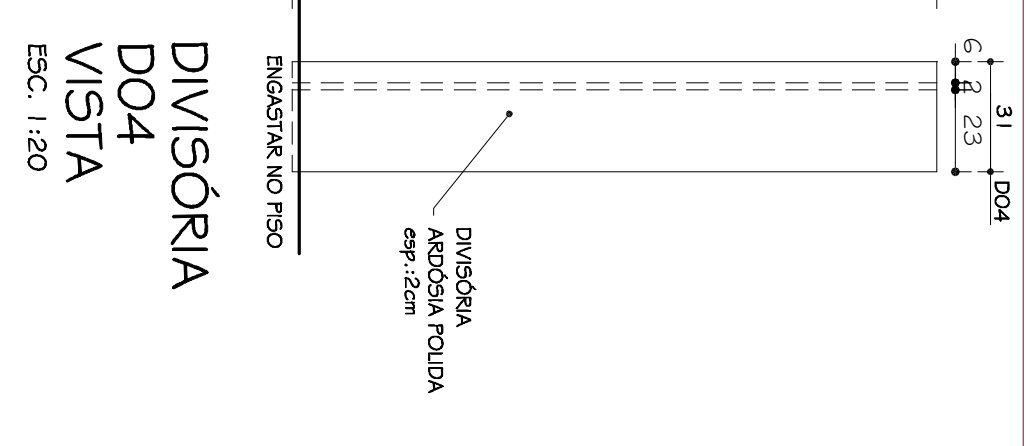

DIVISÓRIA DO4 VISTA ESC. 1:20

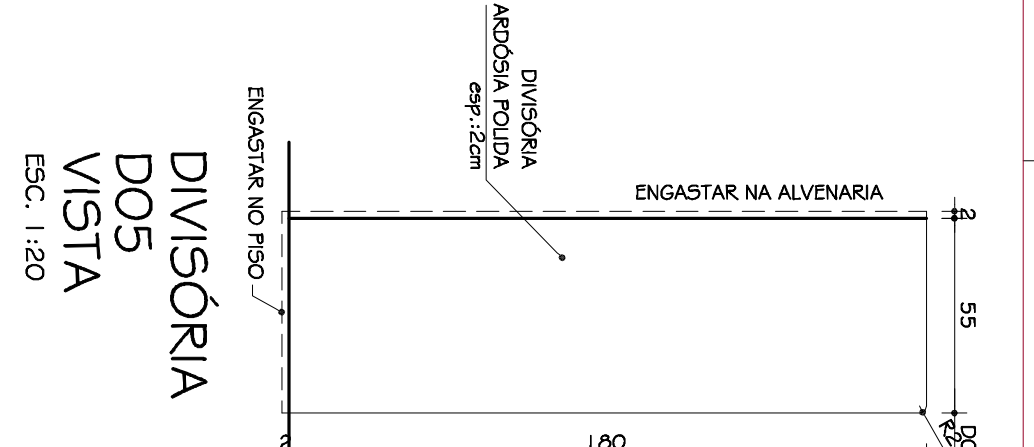

DIVISÓRIA DO5 VISTA ESC. 1:20

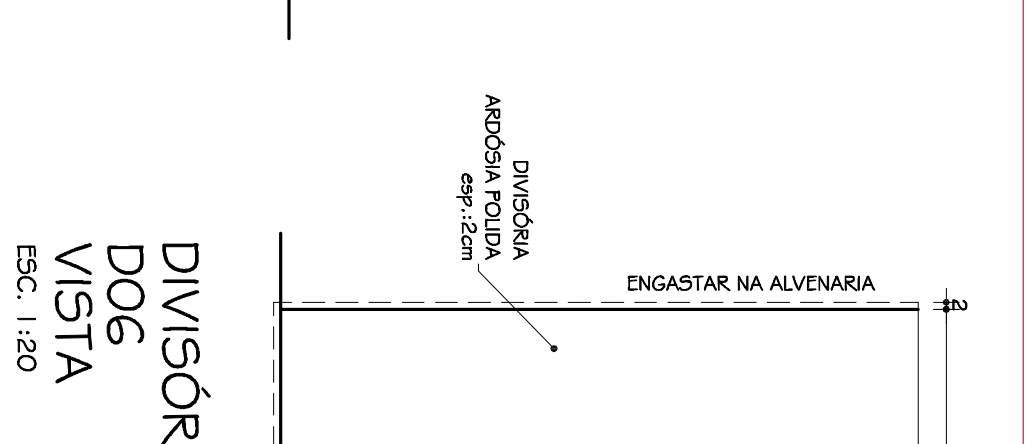

DIVISÓRIA DO6 VISTA ESC. 1:20

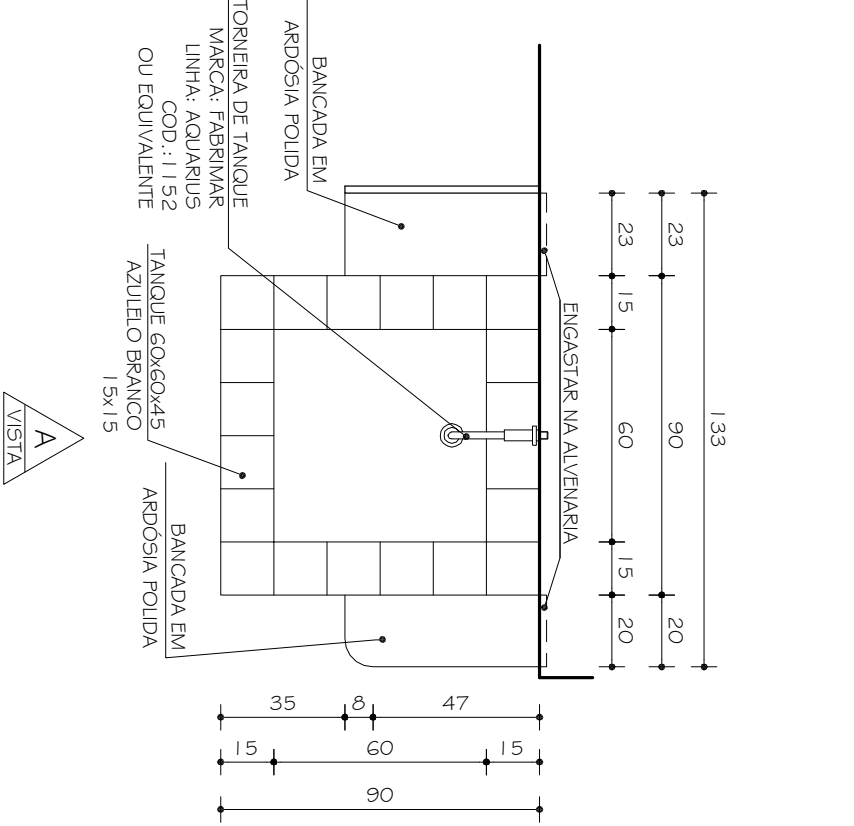

BANCADA B1 / TANQUE TQ1 VISTA A ESC. 1:20

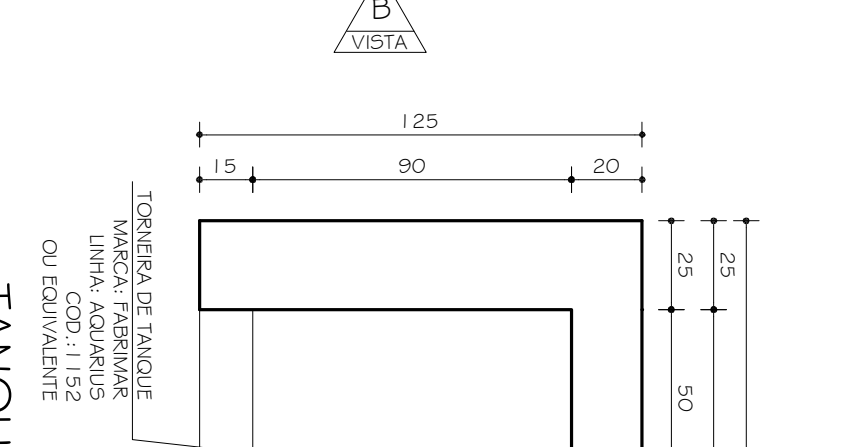

BANCADA B1 / TANQUE TQ1 VISTA B ESC. 1:20

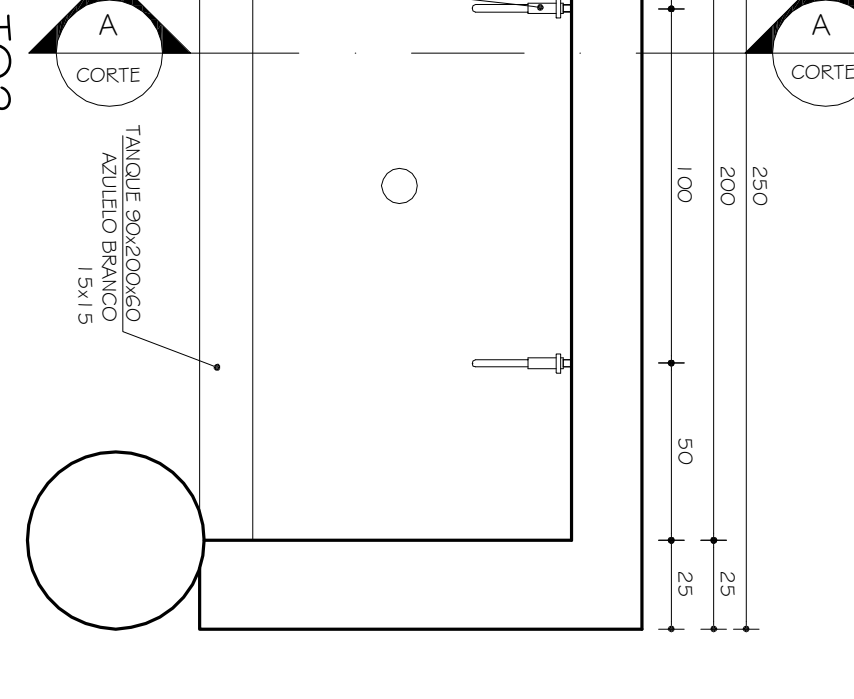

TANQUE TQ2 VISTA A ESC. 1:20

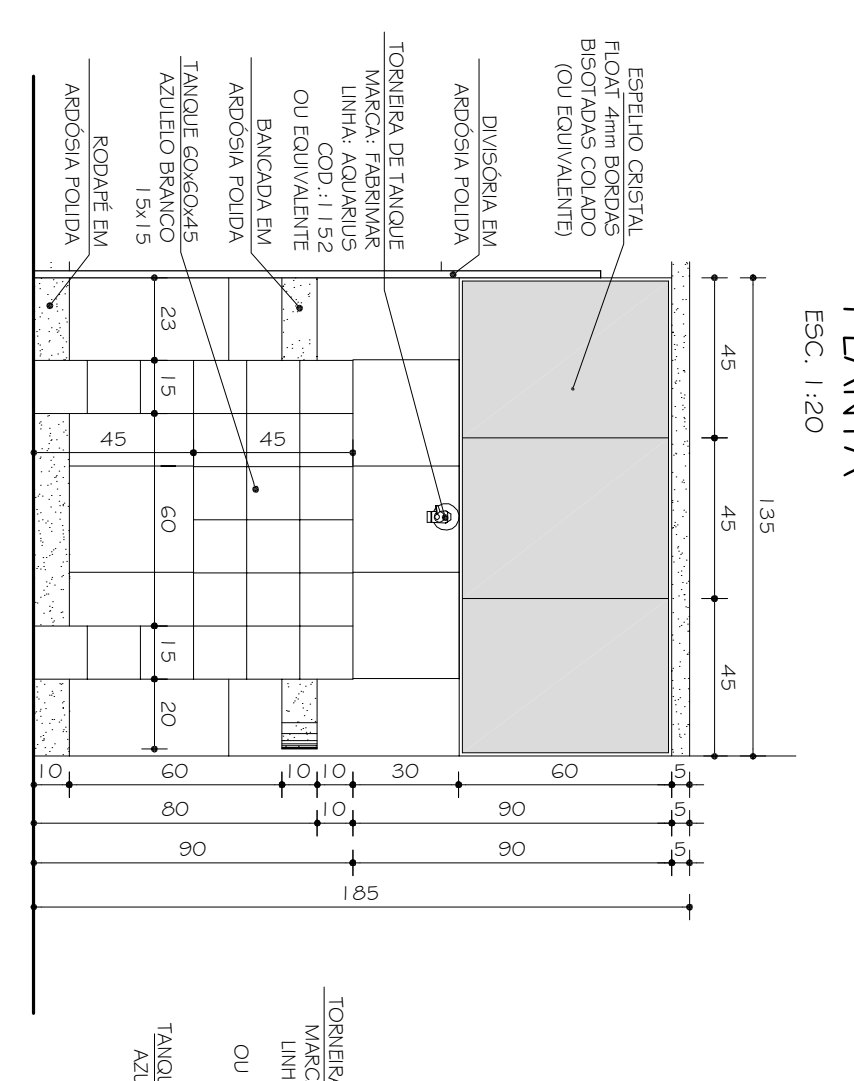

BANCADA B1 / TANQUE TQ1 VISTA A ESC. 1:20

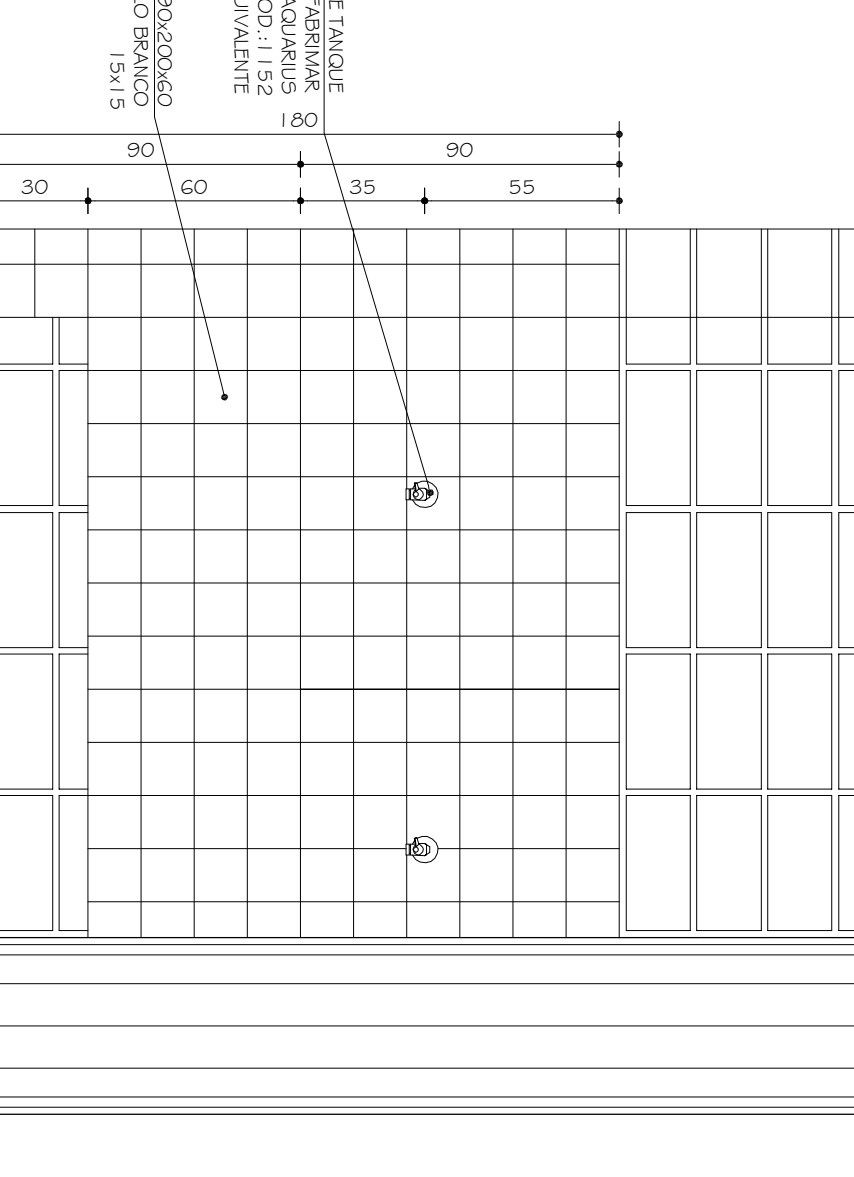

TANQUE TQ2 VISTA A ESC. 1:20

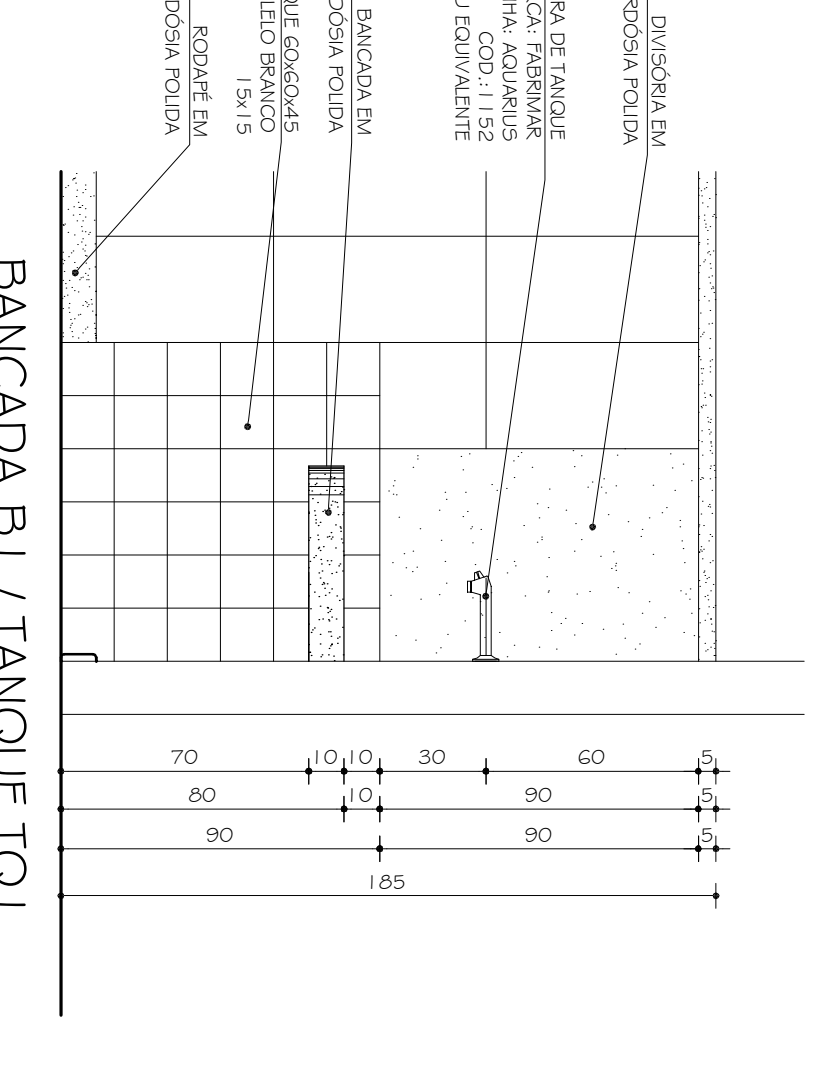

BANCADA B1 / TANQUE TQ1 VISTA B ESC. 1:20

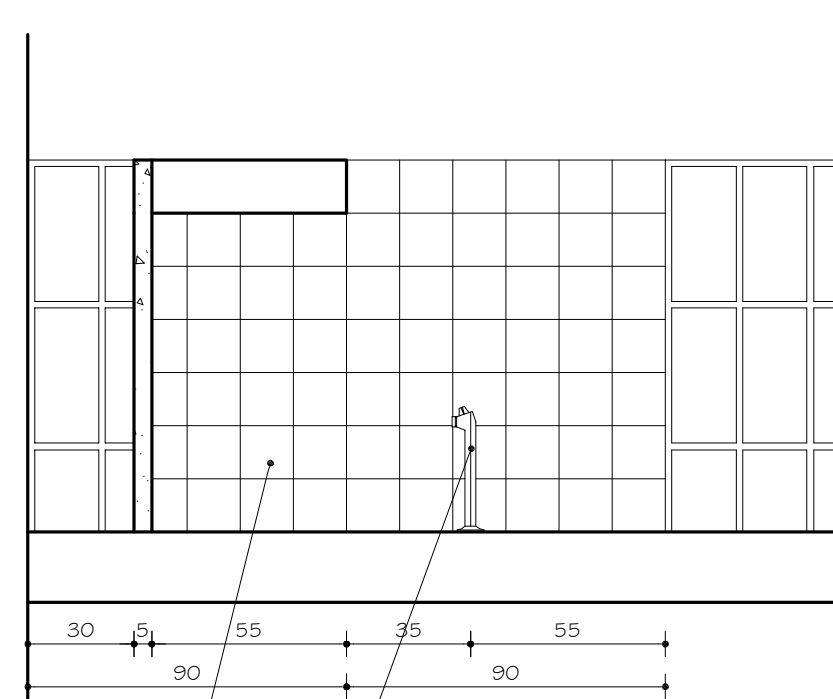

TANQUE TQ2 CORTE AA ESC. 1:20

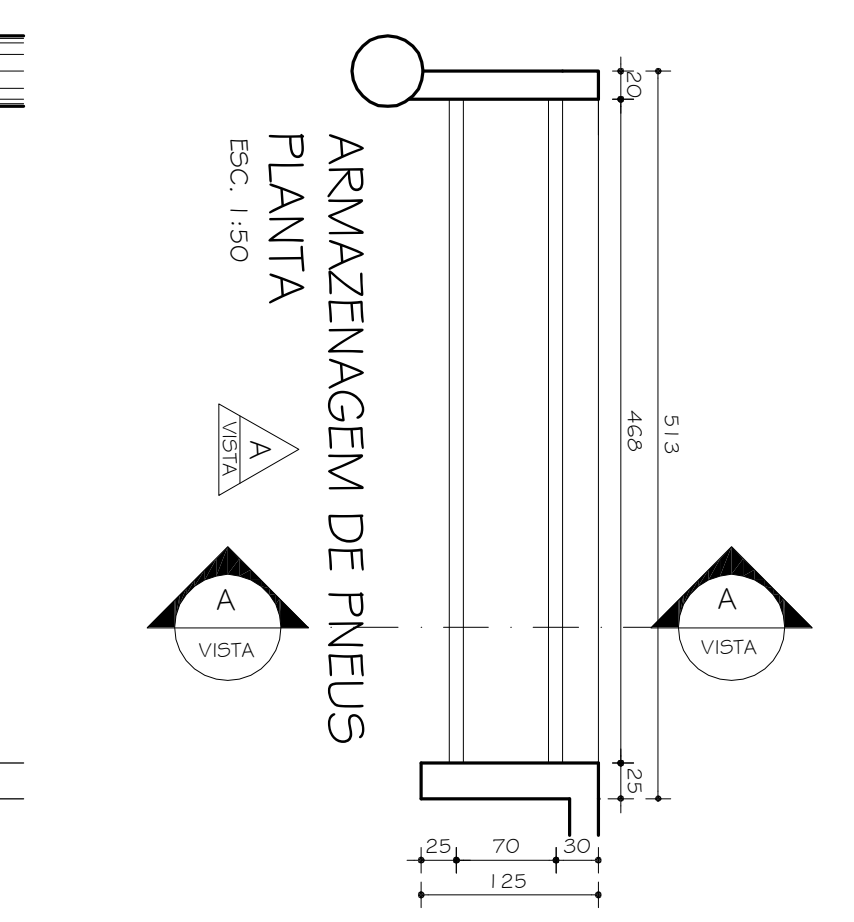

ARMAZENAGEM DE PNEUS PLANTA ESC. 1:50

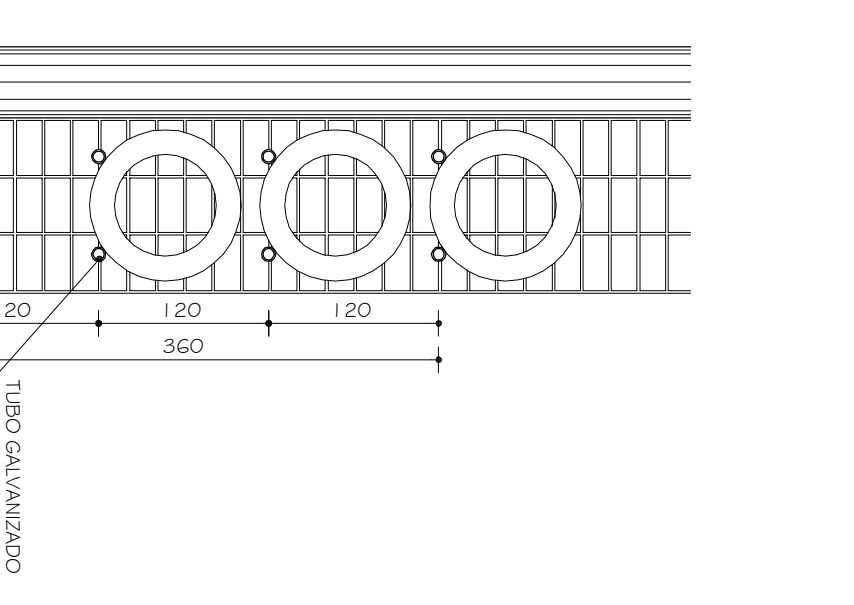

ARMAZENAGEM DE PNEUS CORTE AA ESC. 1:50

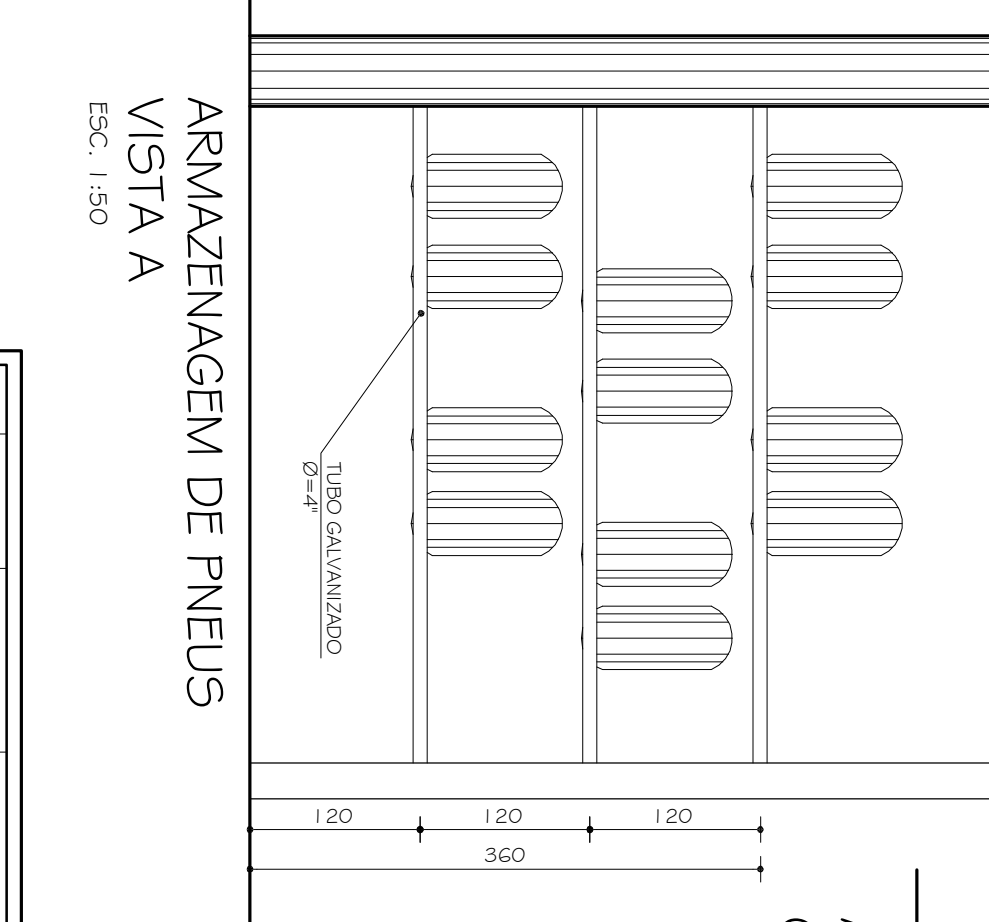

ARMAZENAGEM DE PNEUS VISTA A ESC. 1:50

TP	DATA	RESPONSÁVEL	DESCRIÇÃO DO REVISÃO
PROJETO ARQUITETÔNICO EXECUTIVO			
CONFERRIR MEDIDAS NA OBRA			

GALPÃO DE TRANSPORTE
CAMPUS TEOFILO OTONI

PROJETADO: UNIVERSIDADE FEDERAL DOS VALES DO JACUIBÁ - DIAMANTINÁMS
 RODOVIA MG 367, KM 593, Nº 5000 - ALTO DA JACUIBA - DIAMANTINÁMS
 CDD: 11.52

TÍTULO: DETALHAMENTO DO VESTIÁRIO E ARMAZENAGEM DE PNEUS

AUTOR PROJETO ARQUITETÔNICO RT: KARENINA MARTINS VALADARES
 CREA: 100.999/D-1/MG

VERSÃO: 1
 DATA: 17.11.2009
 AUTOCAD: ARO: KARENINA

ARQUIVO: GALPÃO DE TRANSPORTE TO - FRANCHA 4

FOILHA: 04/04

UFVIM